

**Boardwalk**

# Avonleigh Road

## BEDMINSTER

APPROXIMATE FLOOR AREA  
43.2 SQM / 465 SQFT

### BOOK A VIEWING

01179 898 222

hello@boardwalkpropertyco.com



GROUND FLOOR  
465 sq.ft. (43.2 sq.m.) approx.

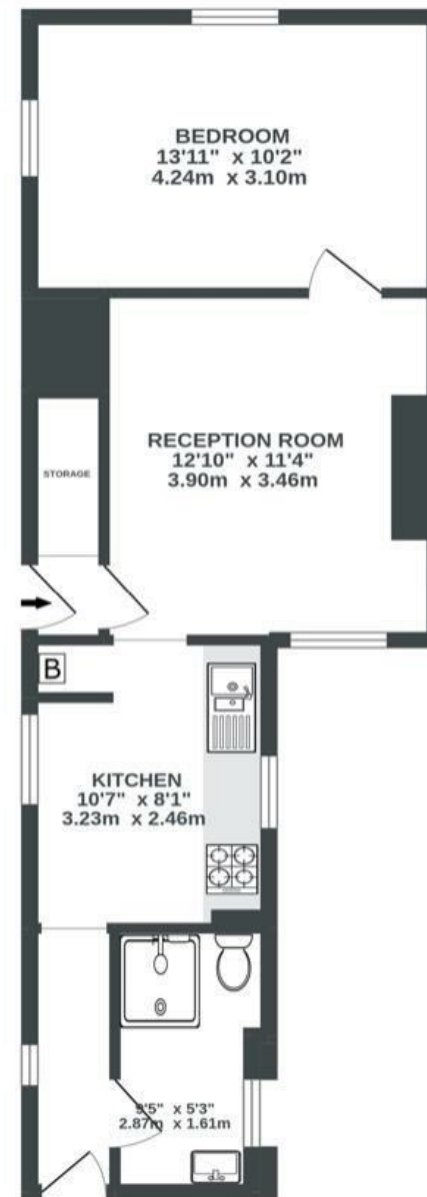

Illustrations are for reference purposes only, measurements are approximate, not to scale.

**Boardwalk**

# Avonleigh Road

BEDMINSTER, BRISTOL

£

£240,000



Bristol, BS3

31A

zzz

1 Bedrooms



1 Bathrooms

"We have truly transformed the space, allowing us to express our creativity and vision. The flat itself boasts tonnes of natural light throughout the day and the bonus of the newly decked-out garden has meant we have been able to enjoy the summer months BBQing and entertaining friends and family as well as growing our own tomatoes!"

We love that Avonleigh Road is within walking distance to the local shops and restaurants on North Street, West Street and East Street making it effortless for you to treat yourself to a tasty meal or a few weekend drinks in some of the amazing restaurants, bars and cafes! Not only are you close to the amenities but great transport links mean that travelling around is completely painless. Living here for the last three years has been an absolute joy!"

